

PLAID®
**gallery
glass**®

Getting Started Guide

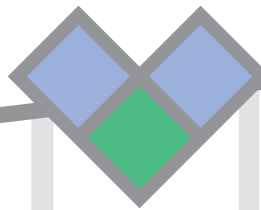

Gallery Glass is a permanent and removable stained glass effect paint.

It is a non-toxic, water-based paint that dries to a vibrant color.

Create the look of real stained glass.

PERMANENT & REMOVABLE

- Gallery Glass colors and liquid leading can be left on display permanently, but can be simply peeled away from most surfaces once dried.

HORIZONTAL & VERTICAL APPLICATION

- Gallery Glass is the only paint on the market that can be applied directly to a vertical surface. No running or dripping.

Tip!

While reading this guide, check these gray boxes for extra tips and trouble-shooting techniques related to the section you're reading.



Quick Guide Table of Contents

Additional Supplies	4
Surface Prep	4
Patterns	5
Practice Pattern.....	6
Outline Techniques	7
Liquid Leading.....	7
Instant Leading.....	8
Peel & Press.....	9
Fill Techniques	10
Shading & Blending.....	11
Adding Texture.....	11
Fixing Mistakes.....	12
Curing Time.....	12
Cleaning	12
Storing & Displaying.....	12
Social Media	13



ADDITIONAL SUPPLIES

- o Glass cleaner
- o Masking tape
- o Ruler
- o Scissors
- o Wipes
- o Paper Towels
- o Notebook paper
- o A glass surface, such as from a picture frame
- o Toothpicks
- o Gallery Glass Tool Set (optional)



Cutter is used to cut leading lines, as well as to remove dried Gallery Glass from surfaces. To use: press button on handle of cutter to release blade, flip blade so sharp edge is facing out, and place back into holder. Push button back into place to lock.

Scraper spreads paint to create sheets of Gallery Glass. Scraper can also be used to assist in removing Gallery Glass from surfaces.

Comb paint back and forth with the pointed side of the **Combing Tool**. Using the flat side of the tool, gently tap the underside of the surface where bubbles are visible to help pop them.

Scoop can be used to remove excess paint. Scoop can also be used to mix colors. Squeeze out the desired amount of each color onto your palette and mix using scoop.

SURFACE PREP

- Before beginning, estimate the amount of Gallery Glass Stained Glass Paint and Liquid Leading you will need for your project. The paint colors provide one square foot of coverage per 2 oz bottle, and the Liquid Leading provides 36 linear feet per 2 oz bottle depending on the thickness of your desired application.
- Thoroughly clean your window or other surface with glass cleaner or soap and water before starting your project.

Basic Tips to Remember:

- Gallery Glass cannot be removed from Plexi-Glass or acrylic surfaces.
- To remove a color before the paint dries, use a cotton swab to remove the unwanted color.
- To intensify or darken a color, apply another layer of paint after the first layer dries.
- To lighten a paint color, mix paint with Gallery Glass Crystal Clear.
- Many of the Gallery Glass Patterns will fit a standard size picture frame (8" x 10", 11" x 14", or 16" x 20")
- Gallery Glass is not recommended for outdoor use.

Patterns

PATTERNS: HOW-TO

- Select your pattern.
- Prepare your work surface: work on a flat surface protected with newspaper.
- Compare the size of your desired application surface to that of your planned design.
- Cut out or copy the pattern from your pattern sheet. For ease, cut to separate patterns from a large pattern sheet.
- Tape desired pattern to backside of your project surface.
- Simply **outline & fill** with Gallery Glass!

Tip!

To alter the size of your design, you can:

- Add borders or make the borders wider.
- Remove the borders or reduce them in size.
- Reduce or enlarge the pattern on a copier, following the guide provided below.

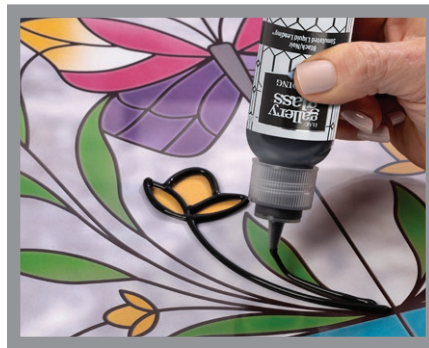
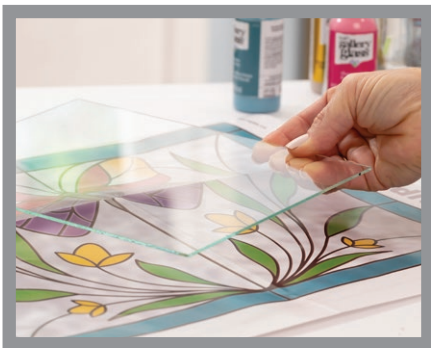

Ratio Formula for Enlarging or Decreasing a Pattern

TO ENLARGE A PATTERN

$$\frac{\text{Desired size}}{\div \text{Size of pattern}} = \text{\% of Enlargement}$$

EXAMPLE

$$\frac{12'' \text{ (desired size)}}{\div 6'' \text{ (current size)}} = 2.00$$

(200% enlargement)

TO REDUCE A PATTERN

$$\frac{\text{Desired size}}{\div \text{Size of pattern}} = \text{\% of Reduction}$$

EXAMPLE

$$\frac{4'' \text{ (desired size)}}{\div 6'' \text{ (current size)}} = 0.66$$

(66% of reduction)

PRACTICE PATTERN

Print this 6" pattern on a standard sheet of 8.5" x 11" office paper and practice your technique.
Or, [click through this link to view Plaid's entire library of free Gallery Glass patterns online.](#)

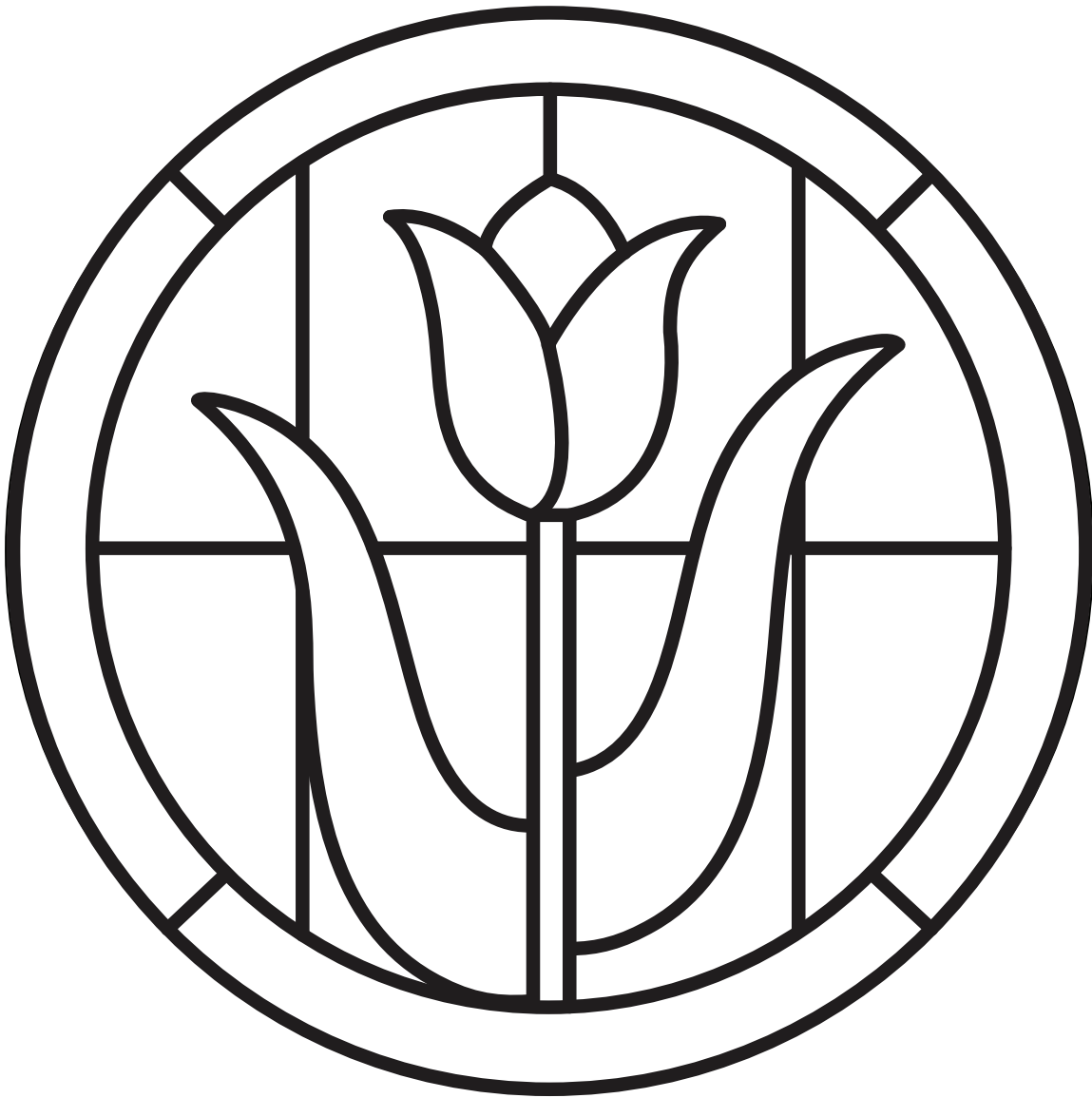

Outline Techniques

LIQUID LEADING

- Apply Liquid Leading from the center of the design working outwards until all pattern lines have been leaded.
- Hold your bottle of Liquid Leading with your whole hand in a vertical position (figure 1).
- Squeeze the bottle. As the leading begins to flow, touch the leading to the surface where you want to begin the line. While keeping the nozzle tip $\frac{1}{4}$ " – 1" above the surface, apply even pressure to create a uniform line of Liquid Leading (figure 2).
- The leading will drape down onto your surface as you squeeze the bottle and follow your pattern. Allow the Liquid Leading line to drape onto the pattern line.
- Continue until all elements of the design have been outlined.
- Uneven leading lines indicate inconsistent speed when moving your arm.
- Bumps at the beginning or end of a line indicate too much pressure.
- Once dry, Liquid Leading errors can easily be removed. Use a razor blade or craft knife to score unwanted sections, peel off, and reapply.
- Leading must dry for 8 hours before painting. Do not dry in an oven or microwave.
- NOTE: Liquid Leading cannot be applied directly to a vertical surface. For vertical application, use Instant Lead or the Peel and Press technique discussed on the next pages.



Figure 1

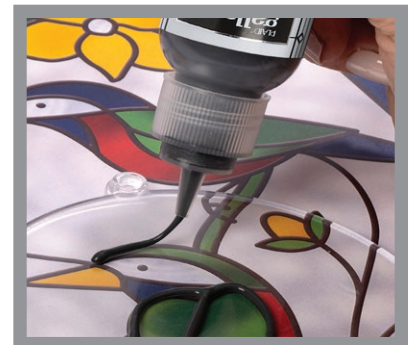
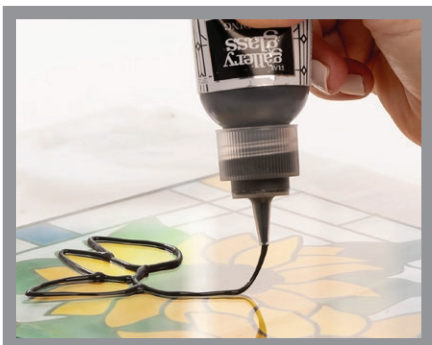

Figure 2



INSTANT LEADING

Instant leading can be used for vertical application. To use:

- Peel strips from packaging and cut to desired size.
- Position on project surface.
- "Solder" joints where strips meet each other with small amounts of Liquid Leading.

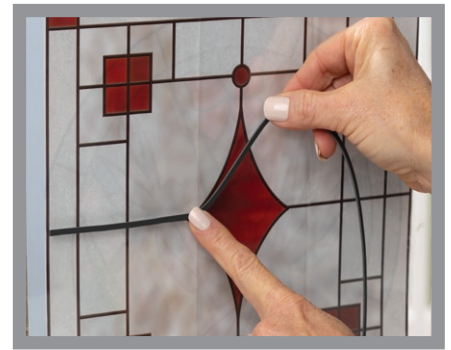

Tip! Creating Fine Outlines

The fine line tip technique is great for personalizing projects, creating thin outlines, and filling in light holes.

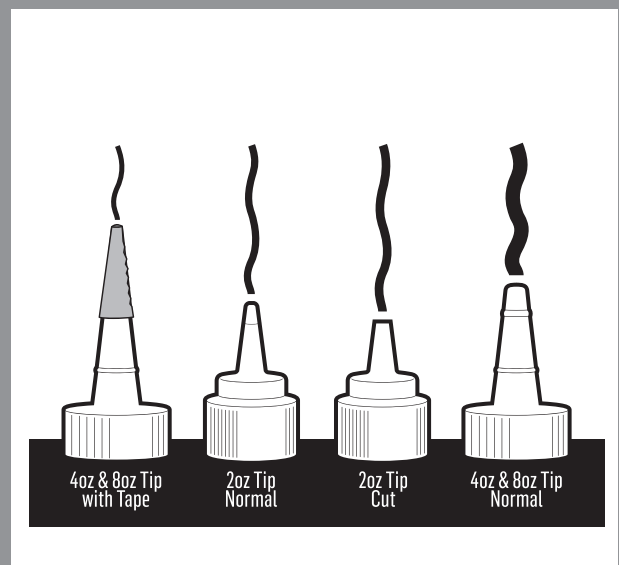
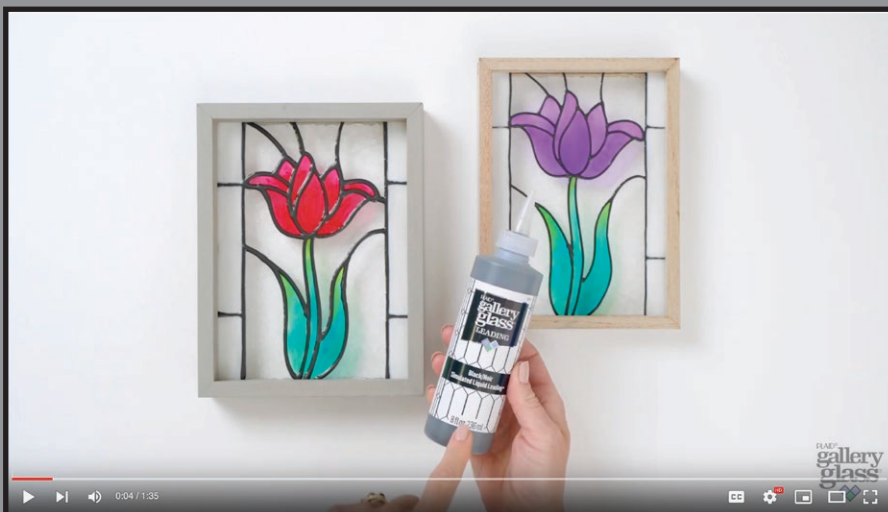

Click through to watch our taping tutorial video!

PEEL AND PRESS

Note: Liquid Leading cannot be applied directly to a vertical surface. Instead, Instant Leading Lines can be used for vertical application, or leading strips can be created using Liquid Leading. To create leading strips, use a flat, horizontal surface to apply Liquid Leading, let dry completely, then peel and press the leading strips on to the vertical project surface.

- Estimate the number of feet of leading you will need by measuring the lines of your pattern.
- Place a clean and empty plastic baggie, stencil blank, or glass from a picture frame over a piece of lined notebook paper. You should be able to see the notebook paper lines.
- Trace over the notebook paper lines with Liquid Leading.
- Continue until you have the correct number of feet of leading needed for your project.
- Leading must dry for 8 hours before painting. Do not dry in oven or microwave.
- When dry, peel up the leading strips and press them on to the project surface, following the pattern lines.
- The leading lines can be cut to the length you need and pieced together end-to-end to make them longer. Do not overlap them.
- Touch up gaps, if needed, with a small amount of Liquid Leading. This step can be done directly on the vertical project surface.



Fill Techniques

Gallery Glass is a non-toxic, water-based paint that dries to a vibrant color to simulate the look of real stained glass. The paint line includes transparent and opaque colors as well as several specialty colors.

HOW-TO FILL

Note: Do not shake.

Paints need no mixing. If bubbles are visible in the bottle, tap the bottle firmly on a table a few times to remove.

TO APPLY HORIZONTALLY (on a flat surface):

- Squeeze the Gallery Glass paint bottle to begin applying paint on the leaded design. First apply the paint to the perimeter of a leaded design section, then fill in (failure to do so may create light holes.) Add a generous amount of paint equal to the leading line level.
- To create beautiful even color, use the pointed end of the Gallery Glass combing tool, a toothpick, or other pointed object to "comb" back and forth quickly in straight lines through the painted section. The tool should touch the edges of the leading lines with each back and forth motion. NOTE: paint applied on the leading will not show when the project is cured.



Paint horizontally.

TO APPLY VERTICALLY:

- Start at the top and apply side to side until you reach the bottom of the leaded section. If combing is desired to even out the color and eliminate visible bubbles, start at the top of the section and comb horizontally through the paint only once, stopping before the bottom to prevent over-runs.



Paint vertically.

REMOVING BUBBLES

Bubbles are the essence of Gallery Glass as they help to simulate the look of real stained glass. If you feel you are introducing too many bubbles into your paint, try:

- **COMBING:** Use the pointed end of the combing tool, a toothpick, or other pointed object to "comb" back and forth quickly in straight lines through the paint while wet. If bubbles persist, comb again in the opposite direction. Clean the combing tool when changing colors.
- **TAPPING:** Lift and hold the project surface firmly in one hand and then tap directly under the combed section with the combing tool or the back of a spoon.

SHADING & BLENDING

- Place a light and dark color from the same color family next to each other in the same section. Comb with the combing tool to blend the two together where they meet. This technique is great for flower petals, leaves, and fruits. Do not comb so vigorously that you mix the paints together, simply comb just enough to blend.
- New colors may be created by inter-mixing any Gallery Glass colors.
- Specialty pigments can be used alone or mixed with Gallery Glass colors.
- Crystal Clear can be used to create a textured background that completes the design for a finishing touch.

For a marbled or opalescent look, first fill an area with one color. Apply dots of a second color. Use the tip of the bottle or a pick to swirl the two colors together.

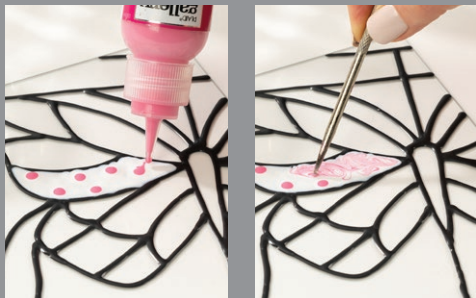

To shade colors, apply two colors side by side. With a pick, gently comb the colors together where they meet, blending them a bit.

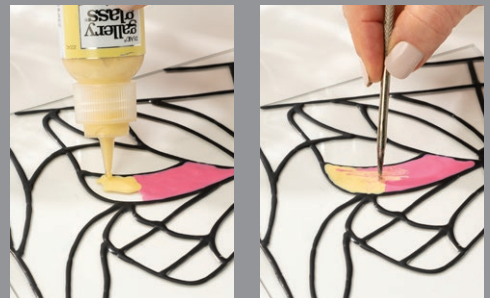

ADDING TEXTURE

- Adding texture to Gallery Glass paint is great for creating privacy windows.
- Interesting textures can be created by brushing Gallery Glass with a brush. A flat or fan brush works best. Make a feathery texture by applying paint with a soft, flat brush. To create this texture, put Gallery Glass paint in a shallow cup. Dip the tips of your brush into the paint. Beginning at edge of the design, make a comma-like stroke first to the right, and then one to the left.
- Apply Crystal Clear with a “swirl” motion using the bottle tip to give the design texture. Let dry. Do not comb or tap.
- When painting with Gallery Glass Frost colors, you can use a sponge with an up and down spouncing motion to create texture.

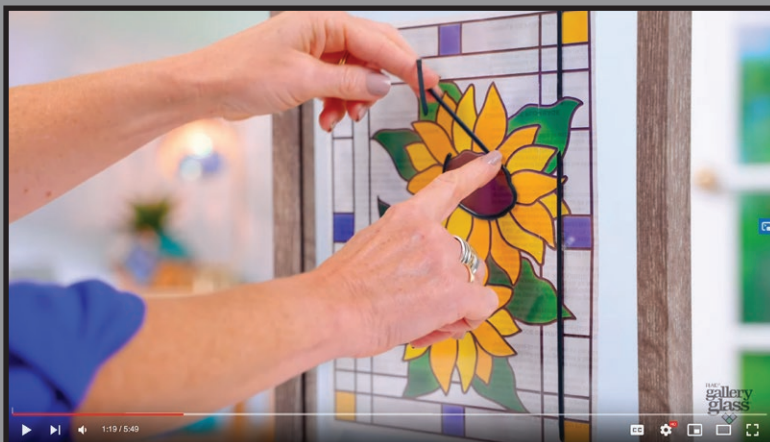

Tip!

Click on the thumbnail to the left to view our Gallery Glass Tips & Tricks video tutorial, covering techniques such as:

- Using Liquid Leading and Instant Leading
- Painting and applying clings
- Removing air bubbles
- Peeling-and-pressing
- Creating textures
- And more!

FIXING MISTAKES

- To remove your design: Use a craft knife to peel up the border, starting in one corner. Slowly peel the entire project from the surface, working toward the opposite corner from where you began. Most projects will peel off in one large piece.
- Change your mind about your design? If needed, you can remove just one or several painted sections that you wish to repaint. Wait until the paint is dry, then use a craft knife or cutter from the Gallery Glass Tool Set to score the paint inside the leading. Simply peel out the paint from that section.
- To remove dried bubbles: Cut edge of bubbly section, peel out, and repaint. Comb with a toothpick or the Gallery Glass Combing Tool to minimize small bubbles and to pop large ones while paint is still wet.

CURING TIME

- Gallery Glass projects usually dry in 24 hours and fully cure in 7 days. Protect your projects from moisture while curing. Drying times vary due to humidity, temperature, and thickness of the paint.
- Once the paint cures, it will withstand cold temperatures unless moisture condenses to the window and freezes. If freeze damage occurs, the area can be repaired. Use a craft knife or safety razor cut the damaged section, remove and repaint.
- Allow project to cure for at least 1 week before cleaning.

CLEANING

- If you spill paint on your clothing, wash it off immediately with soap and water. Do not allow it to dry before cleaning.
- Let project cure at least one week before cleaning.
- Spray a very light mist of water on a soft cloth and wipe the surface gently to remove dust.

STORING & DISPLAYING

- It is best not to allow Gallery Glass projects to come in contact with other surfaces or other Gallery Glass projects as they will stick together.
- To protect Gallery Glass projects, place parchment paper over your project.

Final Reminders

Gallery Glass cannot be removed from Plexi-Glass or acrylic surfaces. Gallery Glass is not recommended for outdoor use.



Social Media/Outreach

Join our community of Gallery Glass crafters!

Share your Gallery Glass creations, ask and answer questions, and get inspired with fellow Gallery Glass fans in the Gorgeous Gallery Glass Facebook Group.

Follow Plaid Crafts on YouTube, Facebook, Instagram, & TikTok for more Gallery Glass inspiration.



Shop Plaid Online

Shop all the Gallery Glass supplies you'll need to get started, including paint kits, tools, surfaces, free patterns and more at [PlaidOnline.com](https://www.plaidonline.com).



Customer Service

If you have questions or concerns and would like to speak to a customer service representative, please contact Plaid for more information: (800) 842-4197